

Baffle Options

BW Blade Baffle, Textured Matte White. One-piece 4' long steel baffle. Radiused Blades are 3/4" high, 1 3/8" OC with four longitudinal shielding rails. Baffles attached to housing with four spring clips. Stainless steel safety tethers are provided at each end to maintain positive attachment to the housing. For 2-lamp cross sections, lamps may be removed/replaced from above without any handling of the baffle.

BWP Blade Baffle, Textured Matte White, Perforated Side Rails. Same as BW baffle with perforated side rails.

Ballast Options specify in place of ELB10

For dimming ballasts:

LPD/ELB 0-10V, low-profile dimming electronic ballast manufactured by a UL-Listed manufacturer, as available, determined by Litecontrol. The minimum number of ballasts will be used. Not available for all lamping combinations. Contact factory to specify a specific ballast.

To have the fixture enabled for Lutron EcoSystem compatibility:

LPD/CS/e EcoSystem low-profile dimming electronic ballasts installed at the factory, along with all required internal EcoSystem wiring. For other configurations of the Lutron EcoSystem components, including custom device connection feeds to enable connection to ceiling-mounted sensors and control devices, consult litecontrol.com or contact the factory.



Tandem Wiring & Circuiting Options

1CWQ Fixture is wired with a single-circuit so that all lamps are switched together.
TW-2CWQ Fixtures wired with two circuits. For fixtures with 2-lamps in cross section, the fixture is wired such that the inline lamps are switched separately. For fixtures with 3-lamps in cross section, the fixture is wired such that the inline center lamps are switched separately from the inline outer lamps.

Other Options

To have the fixture supplied with the daylight harvesting control solution:

Add – **CS/dlh** to the ordering code to have a fixture-integrated daylight sensor by Watt Stopper installed at the factory, along with the appropriate electronic dimming ballast and internal wiring. For row-configured installations, one fixture integrated daylight sensor controls the entire row. Contact factory for details.



Example of Control Solutions catalog number

P-ID-7748T8-BW-CWM-LPD/ELB-1CWQ-CS/dlh-120-FAI/ACC is the catalog number for a 4-lamp (2 lamp in cross-section) 8-foot long indirect/direct T8 fixture with a blade white baffle, finished Matte White, with low-profile electronic dimming ballast, one-circuit branch wiring and quick connects, includes daylight harvesting control solution (daylight sensor), 120 volts, mounted with field adjustable aircraft cable.

Add – **LP/EF** to the ordering code to have a low-profile battery-powered emergency fluorescent ballast installed, manufactured by a UL-listed manufacturer, that will operate one T8, T5 or T5HO lamp for 1 1/2 hours during a power outage.

Add – **F** to the ordering code to have a fuse installed, slow or fast blow, determined by Litecontrol.

Planning for Installation

Row diagram

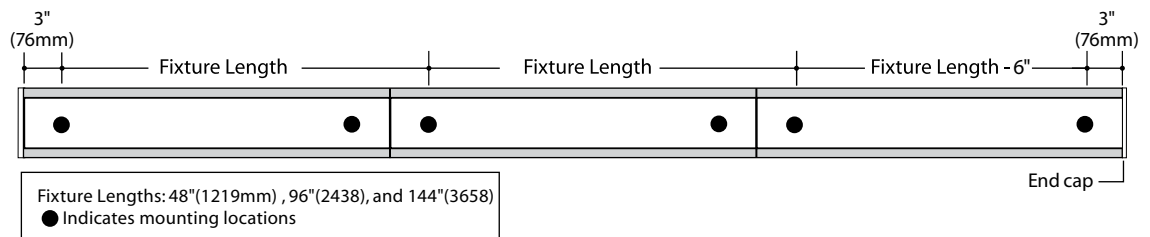

Photometric Data

Consult litecontrol.com for IESNA electronic photometric files.

LITECONTROL

employee owned | customer driven

100 Hawks Avenue Hanson, MA 02341
 781 294 0100 f: 781 293 2849 litecontrol.com

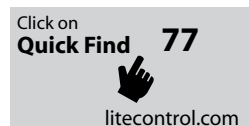



Type:
Project:

CS™ Control Solutions available

SAE P-ID-7700

P-ID-7700

Pendant-Mounted Indirect/Direct

Specifications

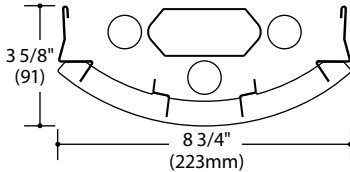

HOUSING. Die-formed steel. Wiring channel cover snaps on/off without tools for easy access to ballast and wiring.
END CAPS. Steel, 14-gauge, with no holes or knockouts, finished to match housing.

LAMPING. Available in two- and three-lamp T8, T5 and T5HO cross-sections.

BALLAST. Electronic Ballast (**ELB10**), high power factor, thermally protected Class P, Sound Rated A, less than 10% THD manufactured by a UL-Listed manufacturer, as available, determined by Litecontrol. Ballasts with a voltage range of 120 to 277 will be used when fixture configuration and ballast availability allow. The minimum number of ballasts will be used.

PRE-WIRING. Fixtures are supplied with #12 AWG type THHN wire for branch circuits. One end will have factory-installed push-in quick-connects. The other end will be stripped back 1/2" for quick connection in field. For fixtures to accommodate special circuits such as night light and emergency, etc., in-field wiring will be required. See online Pre-Wiring Information sheet in Service Center > Downloads at litecontrol.com for details.

BALLAST DISCONNECT. Fixture supplied with a ballast disconnect device to enable compliance with the NEC.

ROW JOINING. Fixture end headers have threaded holes for easy row mounting without removing ballast cover.

SUSPENSION. Aircraft cable or rigid stem pendants attach to fixture housing. Suspension points may be spaced according to fixture housing length, including up to 12 feet apart with 12' fixtures. **FAI/ACC** field adjustable 51" is standard. Suspensions can be installed from above without accessing inside the housing, except at feed locations. See online Aircraft Cables and Stems sheet in Service Center > Downloads at litecontrol.com for details.

CERTIFICATION. Fixture and electrical components shall be UL and/or CUL Listed and shall bear the I.B.E.W., A.F. of L. label. This fixture is Cradle to Cradle Certified™ Silver by MBDC.

Note: Litecontrol reserves the right to change specifications without notice for product development and improvement.

Ordering Guide

Product, Lamping, & Length						Options						
P -	ID -	77	6	8	T8 -	BW -	CWM -	ELB10 -	TW -	2CWQ -	--	120
Mounting	Distribution	Series	Lamp Count	Nominal Length (ft)	Lamp Type	Baffle	Finish	Ballast	Tandem-Wiring	Circuiting	Other Options	Volts
P Pendant-Mounted	ID Indirect/Direct	77	2, 3 → 4, 6 → 6, 9 →	4 8 12	T8 T5 T5HO	BW BWP see Baffle Options	CWM (Matte White) is standard	ELB10 is standard LPD/ELB LPD/CS/e see Ballast Options	-- TW	1CWQ 2CWQ	CS/dlh* LP/EF F see Other Options	120 277
Mounting Options - add to end of catalog number Aircraft Cables <input type="checkbox"/> FAI/ACC (field adjustable) standard <input type="checkbox"/> ACC (fixed) - add LCB for on-grid T-bar canopy box option Stems <input type="checkbox"/> P6S (stem) <input type="checkbox"/> SC/P6 (sloped ceiling) <input type="checkbox"/> EQ/P6 (earthquake)			see notes									
notes: Lamp Count = total number of lamps in the fixture For Ordering guide information in shaded areas, choose selection by reading ACROSS the shaded areas for correct specifications. *Must include a dimming ballast (LPD/ELB). See back for details.												

P-ID-7768T8-BW-CWM-ELB10-TW-2CWQ-120-FAI/ACC is a typical catalog number for a 6-lamp (3 lamps in cross-section), 8-foot long T8 fixture with Matte White blade baffle, Matte White finish, electronic ballast, tandem-wired, pre-wired with two-circuit branch wiring and quick-connects, 120 volts, mounted with field adjustable aircraft cables.

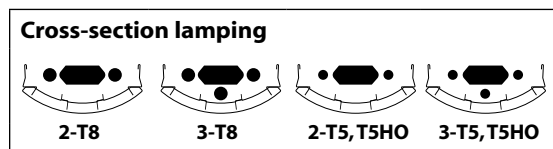

Questions to Ask

1. Row information, including desired fixture lengths?
2. Lamp type?
3. Ballast options?
4. Controls solutions?
5. Other options?
6. 120 or 277 volt?

Click on
Quick Find 77

litecontrol.com