

Wall/Slot-II™

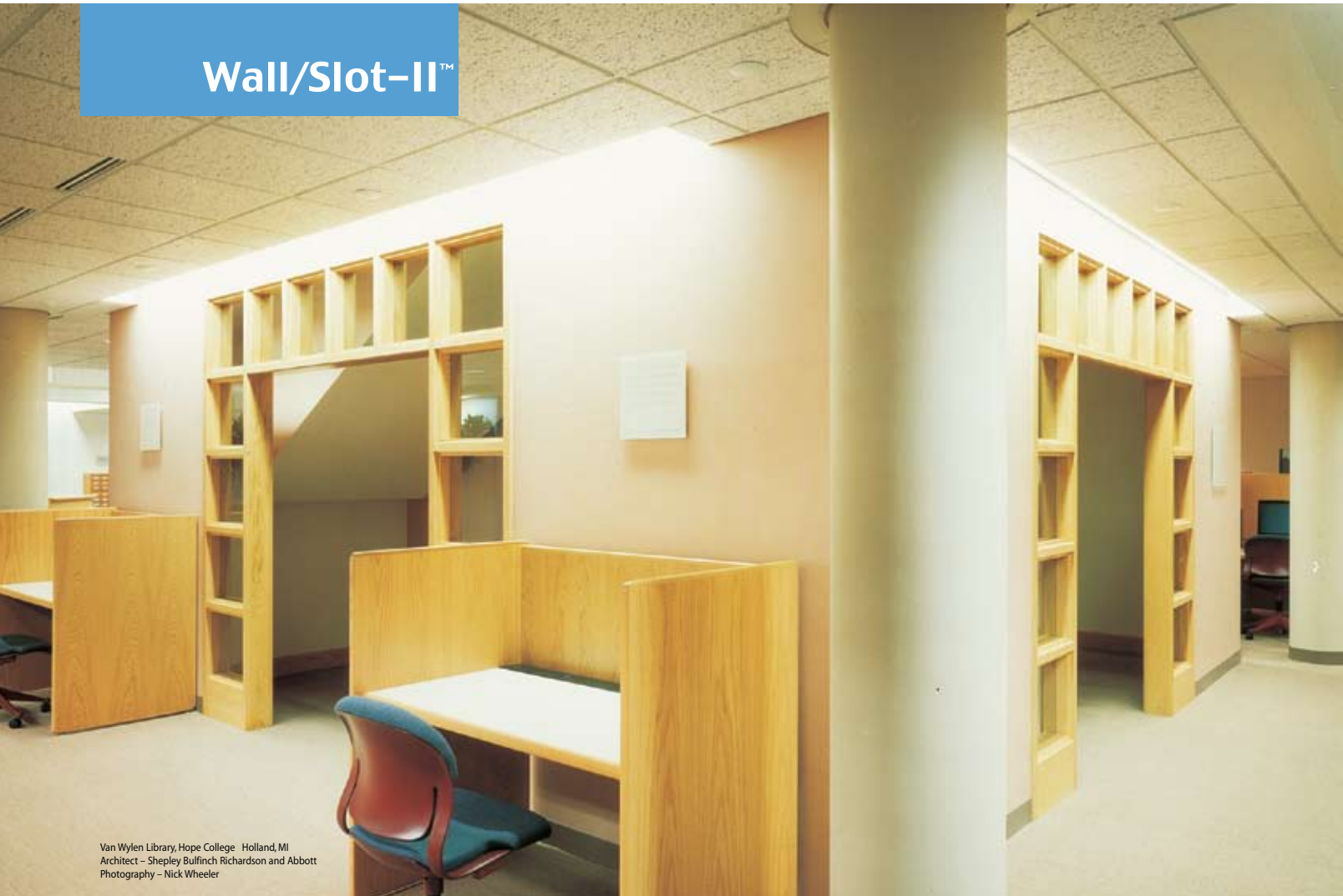

Van Wylen Library, Hope College, Holland, MI
 Architect - Shepley Bulfinch Richardson and Abbott
 Photography - Nick Wheeler

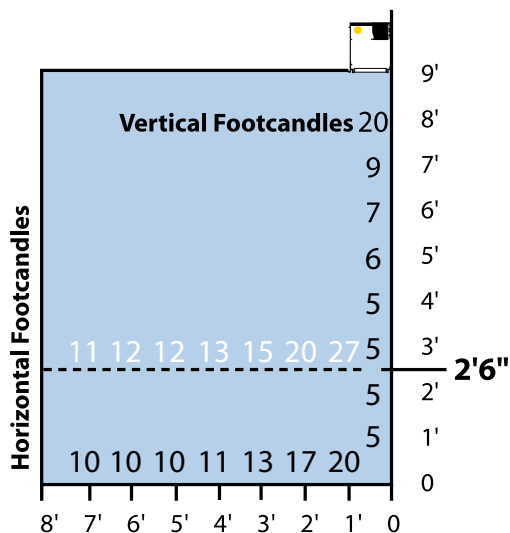

Corridor Application

One 48" row, 1-lamp T8, with flush mounted blade white baffle

- 85N14T8-F/BW
 Reflectances: 80/70/20
 Light loss factor: .75
 Avg. maintained fc at floor: 12

Design elements

- Available in either one- or two-lamp T8 cross-section
- Effectively lights the upper wall to define the space
- Options such as special depth shields and double shields for corridor crossings allow for installation in many applications
- Mitered corner baffles and a unique spline system allow for a continuous slot appearance throughout the space

For further photometric information, see website.



85N

Distribution

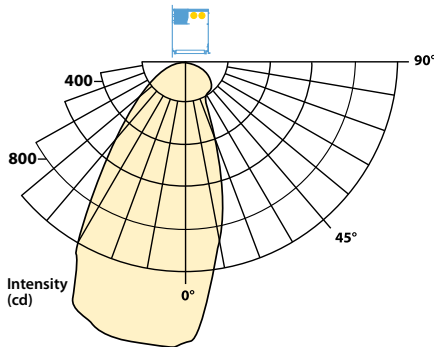

2-lamp T8 BW
(in flush position)

Wall/Slot-II™

Wall/Slot-II is a recessed perimeter fixture that effectively lights the upper wall at the ceiling line. Shielding is extremely flexible, with several choices of lenses and baffles that can be mounted at or above the ceiling level.



p. 240





Wall/Slot-II™ 85N

Product description

Housing has an 18-gauge steel integrated rear support channel with captive leveling screws to provide field adjustment. Extruded white aluminum, wall-mounted rail provides continuous support and alignment of fixtures and components. Rail is designed to provide a reveal at the wall to compensate for irregularities in wall construction. Die-formed 24-gauge steel reflector shields have a continuous channel at the ceiling juncture with locking and splining clips for attaching to ceiling trims. Shields are designed to provide 1 1/2" vertical adjustment. UL Listed. Cradle to Cradle Certified.™

Ordering guide

Product, lamping, & length				Options						
85N -	1	4	T8 -	S/	BW -	CWM -	G -	ELB10 -	EF -	120
Series	Lamp Count	Nominal Length(ft)	Lamp Type	Shielding Position	Baffle or Diffuser	Finish	Ceiling Type	Ballast	Other Options	Volts
85N	1, 2 → 1, 2 → 1, 2 → 2, 4 → 2, 4 →	2 3 4 6 8	T8	F/ R/ S/ see Shielding Position Options	BW FP XA PBSS see Baffle and Diffusers Options	CWM (matte white) is standard	CT CZ DP G see Ceiling Type Options	ELB10 is standard DA/MK7 DL/ECO DO/HEL see Ballast Options	F DS EF PR SDS TW see Other Options	120 277
	see notes									

85N14T8-S/BW-CWM-G-ELB10-F-120 is a typical catalog number for a 1-lamp (1 lamp in cross-section), 4-foot long T8 fixture with blade baffle shielding at top, matte white finish, for mounting in a lay-in ceiling, electronic ballast, fuse, 120 volts.

notes:

Lamp count = total number of lamps in the fixture
 Tandem wiring not available for one-lamp cross-section fixtures

For ordering guide information in shaded areas, choose selection by reading ACROSS the shaded areas for correct specifications.

Shielding Position Options

- F/** Flush shielding, at ceiling line
- R/** Regressed shielding, above ceiling line
- S/** Shielding at top, just below the lamp

Baffle and Diffuser Options

- BW** Blade baffles, matte white finish
- FP** Flat plastic white acrylic diffuser
- XA** Extruded acrylic lens, Patton 12
- PBSS** Parabolic semi-specular baffle (F/ and R/ positions)

Ceiling Type Options

- G** Grid lay-in ceiling
- CT** Concealed T ceiling
- CZ** Concealed Z ceiling
- DP** Drywall or plaster ceiling

Ballast Options

- ELB10** Electronic ballast
- DA/MK7** Advance Mark VII dimming ballast
- DL/ECO** Lutron ECO-10 dimming ballast
- DO/HEL** Osram Sylvania dimming ballast

Other Options

- F** Fuse
- DS** Double shield option
- EF** Emergency fluorescent ballast
- PR** Parabolic reflector (1-lamp only)
- SDS** Special depth shield
- TW** Tandem wired

See litecontrol.com for complete product specifications, including details on row joining, system connectors, suspension and mounting for different ceiling types (as applicable).

Note: Litecontrol reserves the right to change specification without notice for product development and improvement.

Click on **Quick Find 85n**



litecontrol.com

litecontrol.com



Easy installation

- | Mounted using Litecontrol's easy hook-and-lock installation system
- | Supported by an aluminum wall-mounted rail
- | Horizontal and vertical adjustment is possible for appearance and construction variations
- | Corners and extensions can be trimmed in the field

Wall/Slot®-II

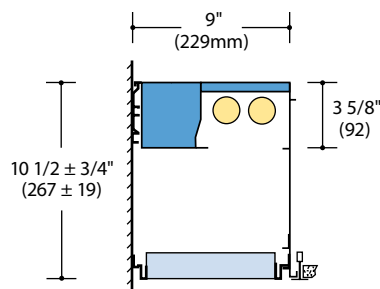

baffle shown in flush F/position

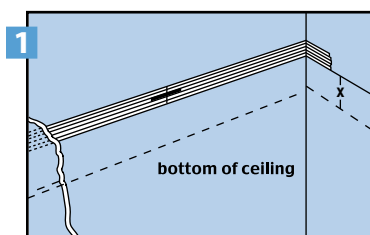

1 Install fixture support rails on walls.

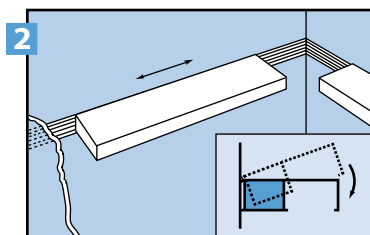

2 Hook fixtures on rail and slide into position.

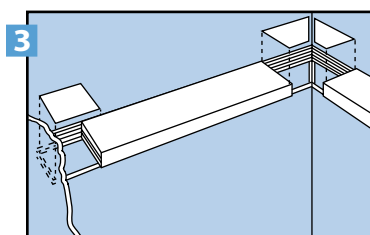

3 Install extensions and corners.

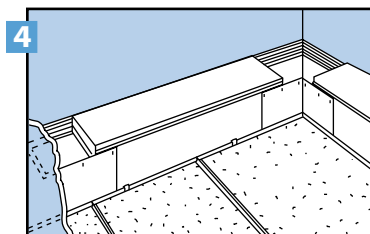

4 Attach reflector shields to fixtures.

